

STUDENT TECHNOLOGY

GETTING STARTED GUIDE



GRADES 3rd – 5th CHROMEBOOK LOG-IN

1. Turn on your Chromebook

- **New model:** Open your Chromebook and it will automatically power on. If it does not, the power button is located on the left side edge.
- **Old model:** Press the Power Button on the top right of the keyboard until your Chromebook begins to light up.



2. Click Scan QR Code

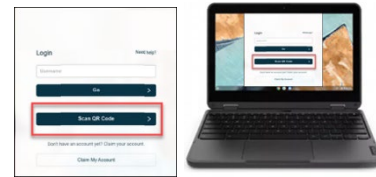

3. When your camera opens, hold your badge up to the camera to scan your QR Code



- #### 4. Follow the on-screen instructions to select your picture pin image
- *You will select your picture pin image on your first login only**



5. Click on Student & Campus Staff Login

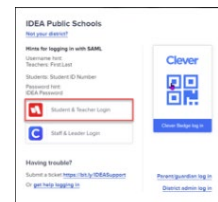

6. You are logged in and learning can begin!

